

# PT10SR-2430

## Lower Pressure Transmitter



### Features

- Full stainless steel construction; compact size; IP65 Protection ;
- Ceramic, stainless steel and Viton contact with media; good corrosive resistance;
- Cavity and non-cavity constructions are optional; wider diaphragm contacting with media to measure large granule or viscous flow media; not easy to jam, and easy cleaning;
- Max. overpressure 10 times, high pressure impact resistivity;
- Explosion-proof product conforms to Standard GB3836.1 and GB3836.4; Ex-proof Certificate is issued, Ex-proof sign: Exia II CT6Ga

### Introduction

PT10SR-2430 lower pressure transmitter is produced especially to measure very low pressure. It uses high-performance pressure sensor and integrated stainless steel full-welded construction, compact size, good overpressure and corrosive resistance, good reliability and reliable performance, the transmitter could be used for lower pressure measurement and control of petroleum, chemical industry, power station, mine, city water supply and drainage and hydrology, etc.

Range code	0D	0C	0B
Measure range	-2.5kPa...-0.5kPa~0.5kPa...5kPa	-10kPa...-1kPa~1kPa...10kPa	0kPa~2kPa...20kPa
Over-pressure	180kPa	200kPa	600kPa

Power supply	12V~28V DC (The Ann model, the security gate power supply)
Output signal	4mA~20mA DC 2-wire
Load	$RL \leq ((U-12V)/0.02A) - R_w (\Omega)$ , U is power supply voltage, $R_w$ is wire resistance
Accuracy	$\pm 0.5\%FS(\text{min.}) \quad \pm 1.0\%FS(\text{typ.})$
Thermal error	$\leq \pm 0.15\%FS/10^\circ\text{C} (-20^\circ\text{C} \sim 80^\circ\text{C})$ $\leq \pm 0.2\%FS/10^\circ\text{C} (-30^\circ\text{C} \sim -20^\circ\text{C})$
Long-term stability	$\leq 0.5\%FS/\text{year}$
Shock	$\leq \pm 0.01\%FS$ (X, Y, Z axes, 200Hz/g)
Environment temp.	-30°C ~80°C      -10°C ~70°C (Cable) -10°C ~60°C (Exia)
Media temp.	-30°C ~80°C
Storage temp.	1 -40°C ~120°C      -20°C ~85°C (Cable)
Protection	IP65(Code I Code II ) IP68(Code III )
Pressure port and housing	Stainless steel 1Cr18Ni9Ti
Sensor diaphragm	96% alumina ceramic
Sealing parts	Viton

**Outline Construction** (Unit: mm)

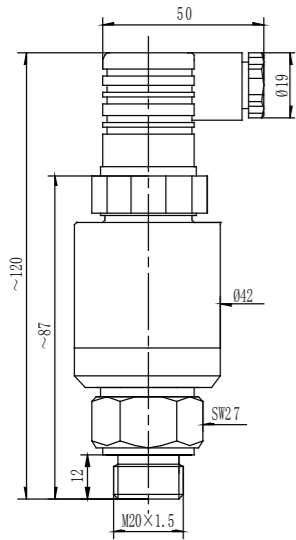

Code I General Type

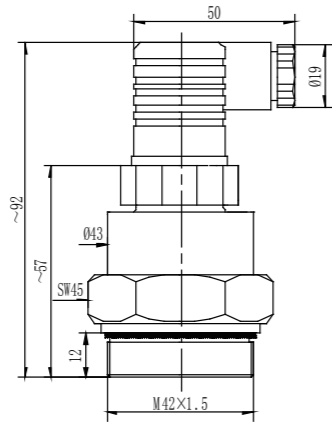

Code II No-cavity Plug Connection

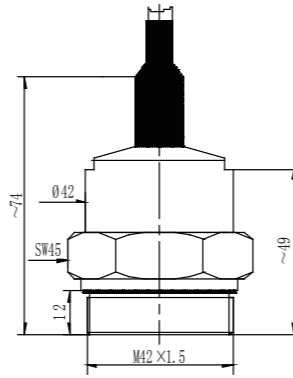

Code III NO-cavity Cable

**Electrical Connection**

Wiring	Plug connection	Cable connection
+V	Pin 1	Black wire
0V/OUT	Pin 2	Red wire

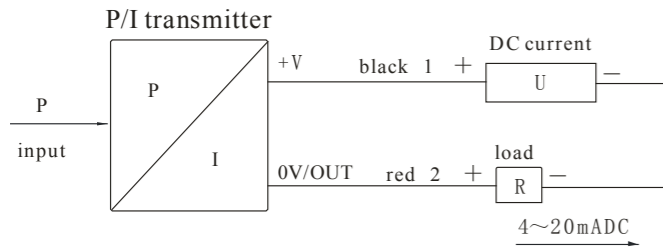

**Order Guide**

PT10SR-2430		Lower Pressure Transmitter				
[0~X]L	Code	Pressure range				
	0D	-2.5kPa...-0.5kPa~0.5kPa...5kPa				
	0C	-10kPa...-1kPa~1kPa...10kPa				
	0B	0kPa~2kPa...20kPa				
Range	Measurement range Pa or kPa, X=actual pressure range; L=cable length for cable connection type transmitter, unit: m					
E	Code	Output signal				
	E	4mA~20mA DC				
I	Code	Others				
	I	General type(M20×1.5 male)				
	II	Non-cavity plug connection(M42×1.5 male)				
	III	Non-cavity cable connection(M42×1.5 male)				
		Code	Others			
	i	Intrinsic safe version Exia II BT6 Ga				
	G	Gague				
	A	Absolute				
	N	Available to measure vacuum				
PT10SR-2430		[-2~10]kPa	E	I	GN	the whole spec

**Notes**

- 1.Please note needed accuracy in the order; the default is 1.0%FS;
- 2.If the user needs pressure type Absolute, the min. range is [0~3] kPa, no N option could be provided; if the user need Gauge pressure type, as well as vacuum measurement, please select both G and N. the min. range is -0.5kPa~0.5kPa.
- 3.If the user has special requirement, please feel free to contact our company.

<http://www.zoricreato.com>

588: 6i ] `X] b[ ` &szBc` \*z<Yb[ nY` Gy Yb` GhfYYh` Mb[ ` Y` 9Wtba] W8Yj Y` cdaYbh` NcbYz6Y` ^] b[ ` z7\` bU`

Hf` : 010-51669912